



Aqualitec
Screening Equipment

SCREENTEC, THE PUMP STATION BAR SCREEN



Aqualitec
Screening Equipment

Agenda

- Nationwide Sewer Issues
- Screentec, THE Pump Station Bar Screen
- Screentec Case Studies
- Conclusion



■ Nationwide Sewer Issues



- **Non-dispersibles** are clogging the nation's sewer systems.
 - Hand wipes
 - Disposable cleaning wipes
 - Shop rags
 - Other sanitary items
- **Hazardous to pump equipment** because they don't decompose
- Maintenance, repairs, and new pump investment **expenses are rising rapidly.**



Products

- Flushable vs Non- Dispersible



Non-Dispersibles Sales

- Growing rapidly – 150% in ten years
- \$12 billion today, \$16 billion by 2017

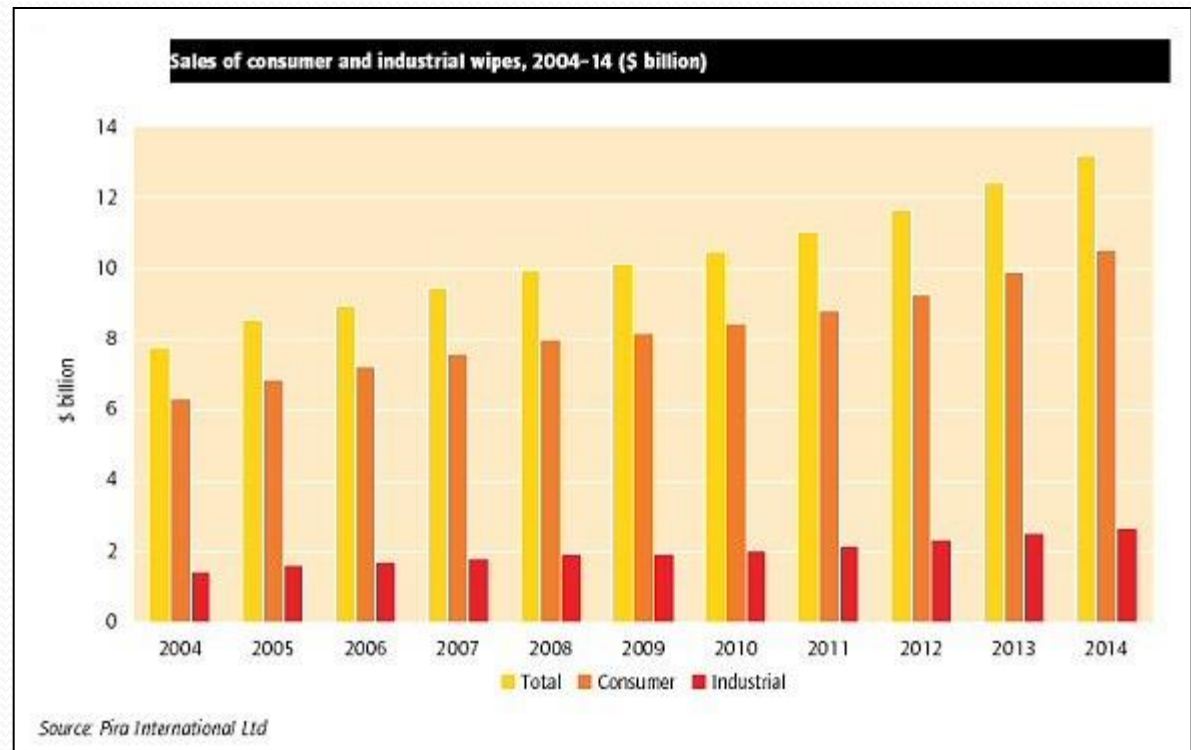

Non-Dispersibles Foul Pump Equipment



Pumps clog videos.asx

Pump Maintenance

- Expensive
- Hazardous



- Non-dispersibles **damage** expensive pumping equipment
- Debris **damage** frequently requires pump replacement
- **Reduced system productivity, efficiency**
- Non-dispersibles cause difficult and dangerous maintenance
- Taxpayers spend **hundreds of thousands of dollars** on **unnecessary** recurrent expenditures.



Solution Alternatives



Change behavior of millions of people...

Solution Alternatives



Screen and clean pumps manually – expensive and hazardous

Solution Alternatives



Use grinders – often requires extensive plant modifications,
and still prone to non-dispersible damage



■ Screentec, THE Pump Station Bar Screen



Vertical Design

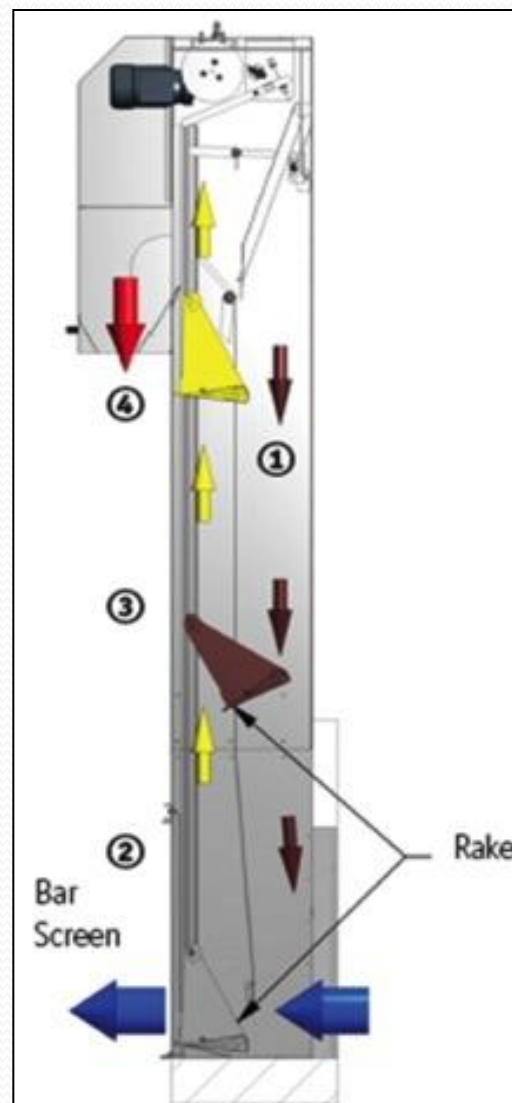



- Fits confined pump station, lift station and manhole spaces

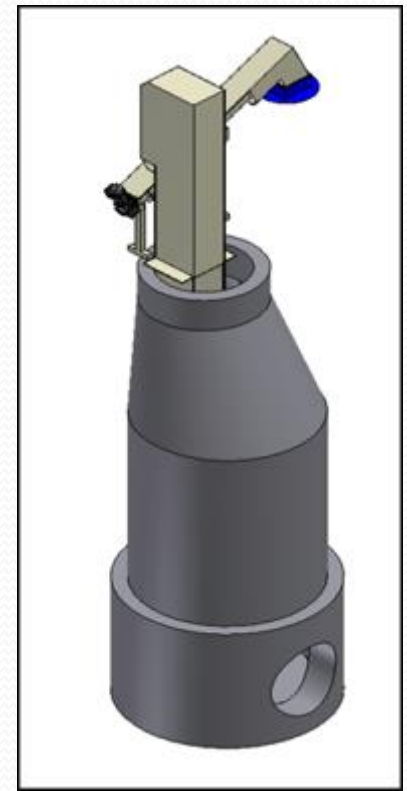
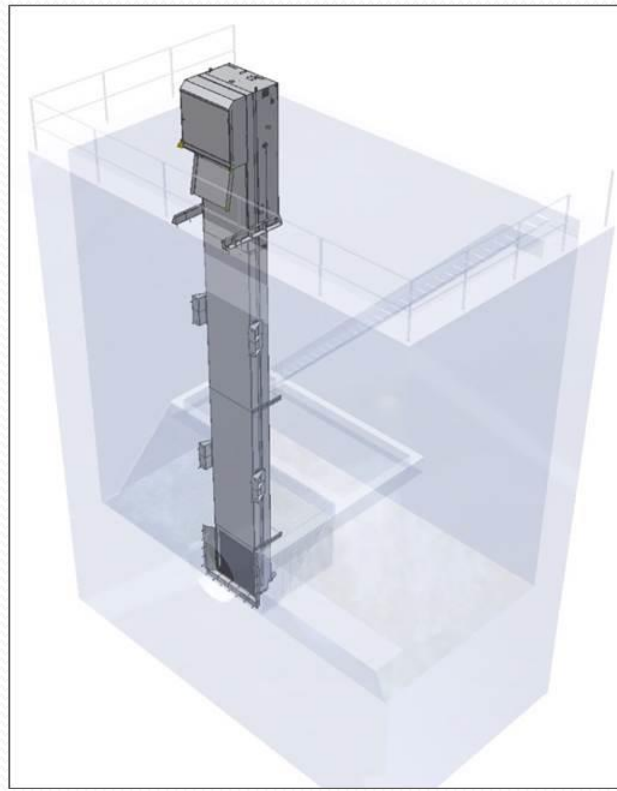
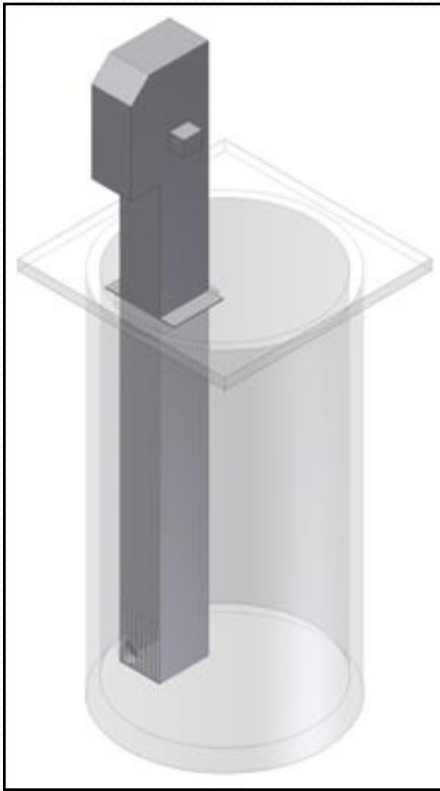



- No maintenance below grade level

Screentec's design excludes moving parts, removing the requirement for unsafe manual maintenance

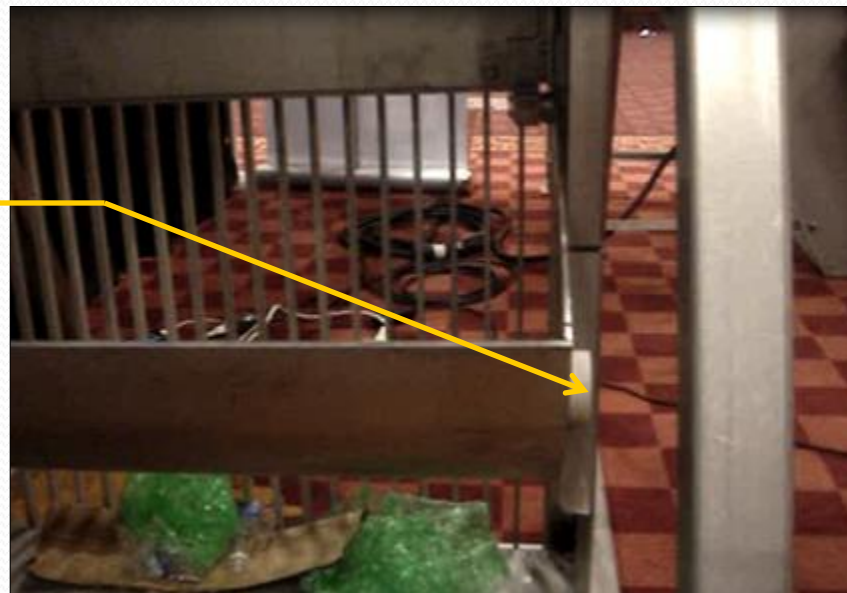



- No depth restrictions

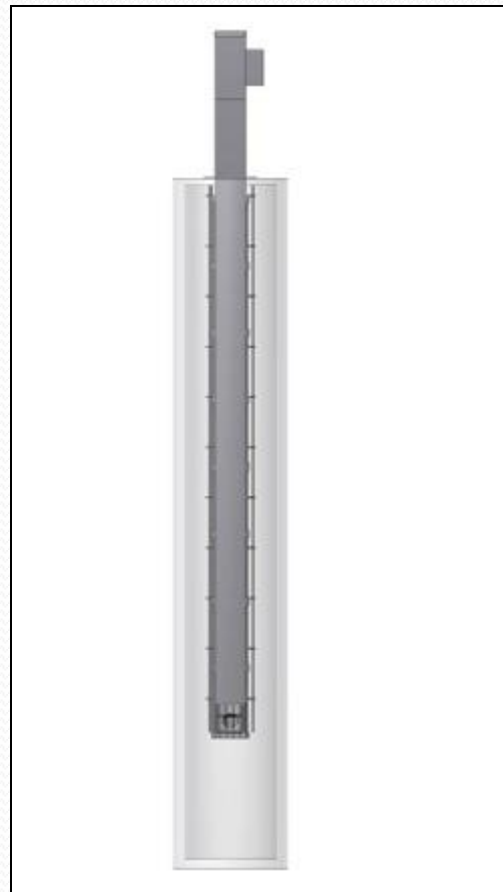
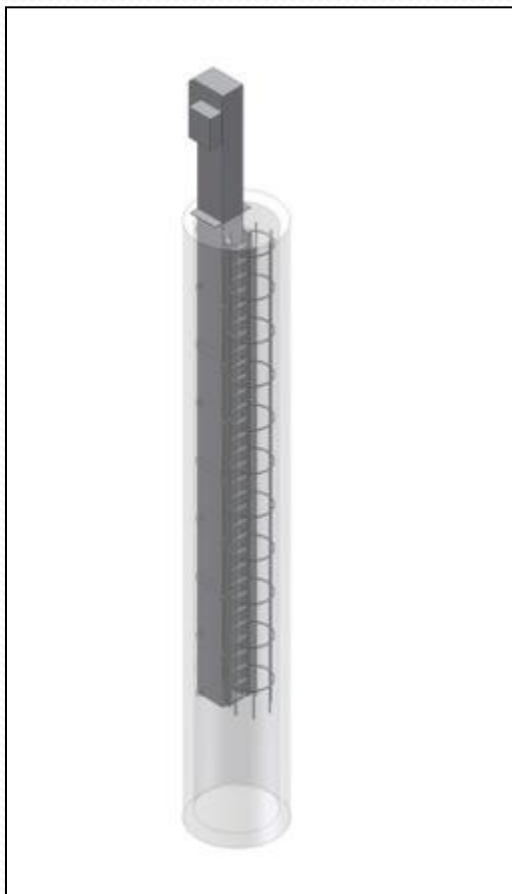



- Low Energy Consumption

$\frac{3}{4}$ hp Sew-Eurodrive Gearmotor



- **Protects pumps** from all debris, including non-dispersibles.
- Maintains system **productivity and up-time**
- No more dangerous and costly maintenance
- **Easy installation** with minimal retrofit
- Ongoing **maintenance savings**
- Reduces costly pump repair and replacement costs
- **Taxpayers save hundreds of thousands of dollars**



■ Screentec Case Studies



Case Study: Lower Township, NJ

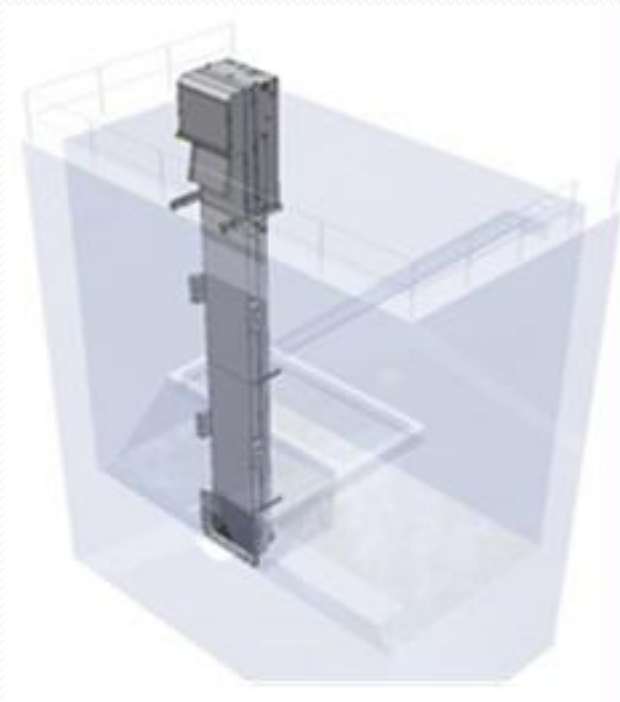

**Lift Station
Click**

- Previous operation:
 - Manually-cleaned 2.5" grating located 23'-0" below grade





- Recurrent issues
 - \$72/day in manual labor to protect pumps
 - Hazardous environment (H₂S)
 - Structural constraints





Case Study: LTMUA

- Screentec saves LTMUA \$26,280 every year

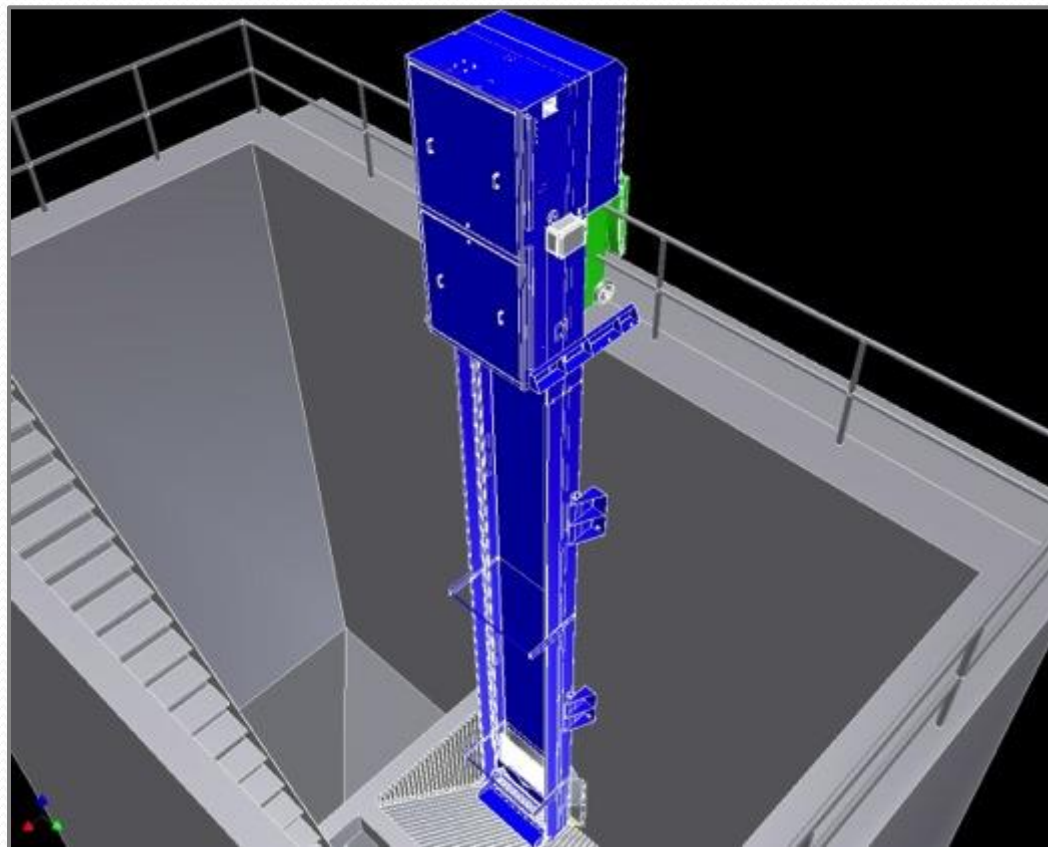



- Simple installation



LTMUA.wmv



- Inexpensive solution with ongoing savings
- Manual labor —————> Mechanical operation
- Unsafe environment (H₂S) —————> No below-grade maintenance
- Structural constraints —————> No structural changes





Case Study: Mendocino, CA



**Deep Well
Click**



- Previous operation
 - Confined space, outdated Headworks, limited budget



- Recurrent issues
 - Manual Labor to protect pumps
 - Unsafe Environment (H₂S)
 - Structural Constraints





- Screentec fit the small-diameter, deep pump location

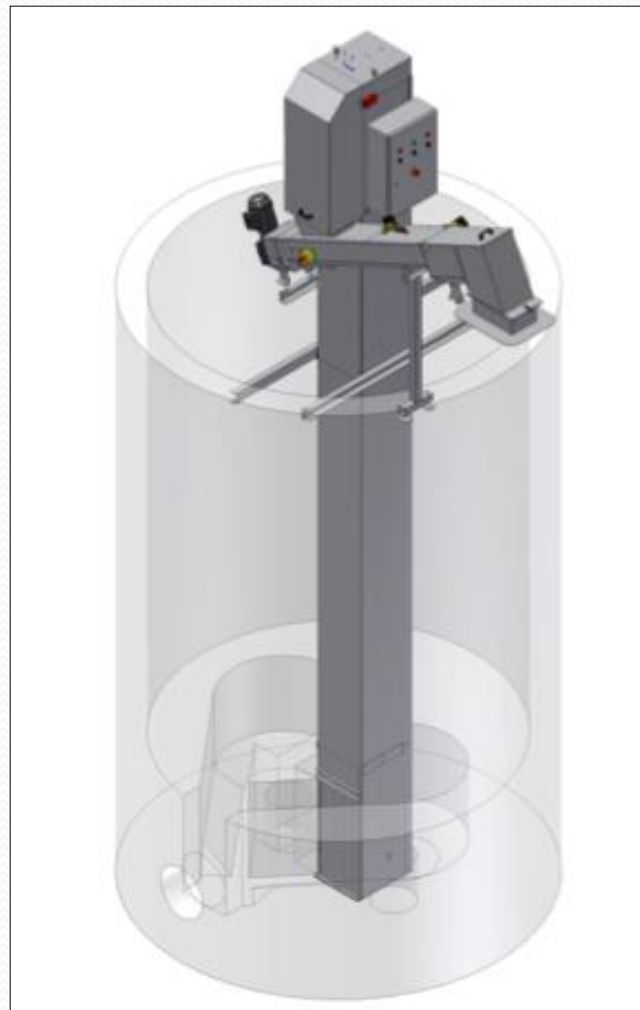

- Current Operation



Mendocino.wmv



- Significant savings with a small investment
- Manual labor —————> Mechanical operation
- Unsafe environment (H₂S) —————> No below-grade maintenance
- Structural constraints —————> No structural changes





■ Conclusion

- Screentec allows wastewater operators to protect expensive pump equipment from non-dispersible debris.
- Screentec's versatile design fits almost any application with minimal retrofit.
- Screentec's automatic operation frees operators from costly and dangerous manual maintenance.



Screentec's simple, versatile design makes it affordable, effective, and reliable.

Contact Information

Erwan Ouattara

- (310) 926-3118
- eouattara@aqualitec.com

Olivier Monfort

- (310) 703-2174
- omonfort@aqualitec.com

